

Wright Elementary

Final Plans

Gym addition and renovation

Board Meeting
December 13, 2016



Think. Learn. **Grow.**

www.dmschools.org

Site Plan



Overall floor plan

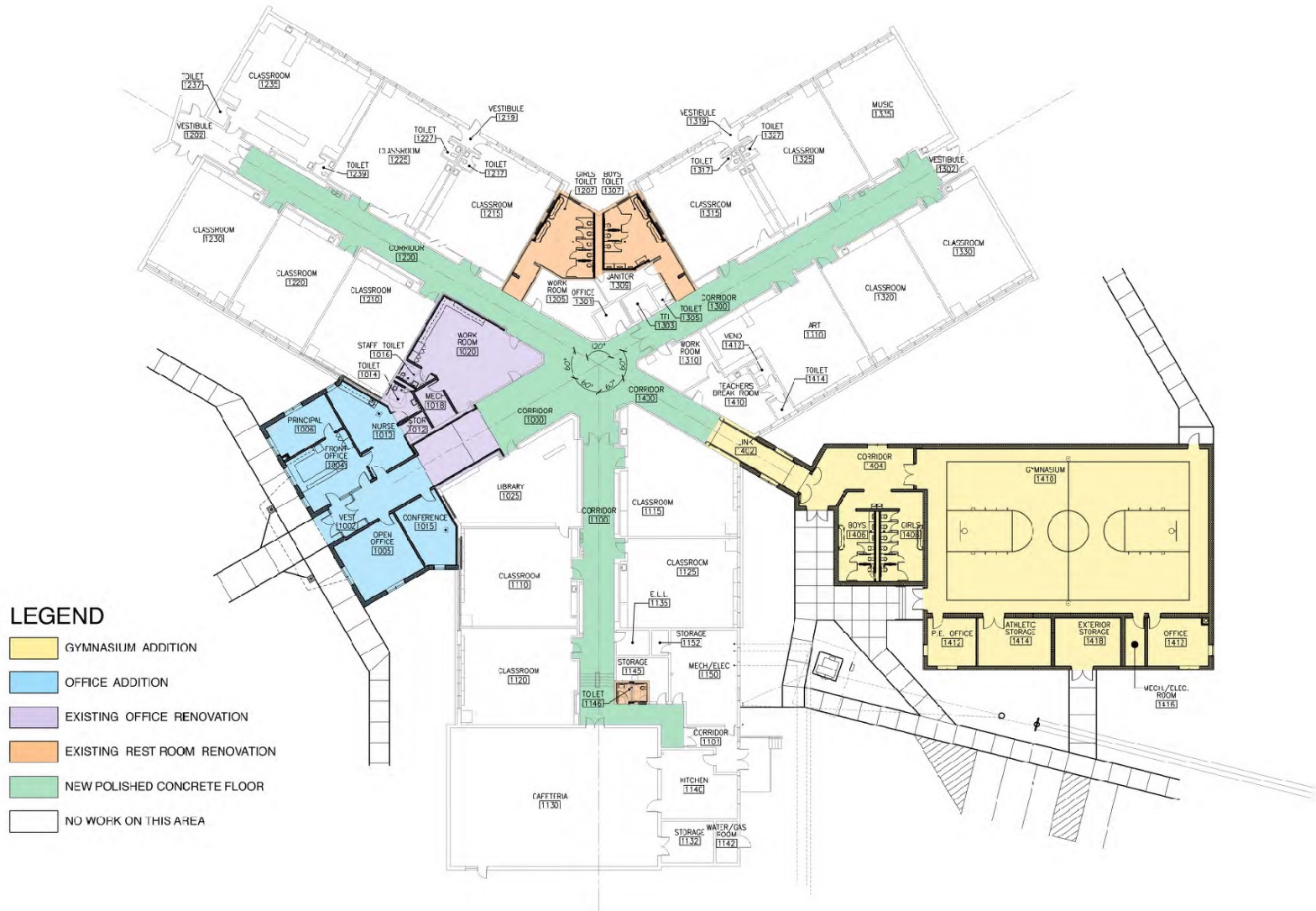

Floor plan - Gym

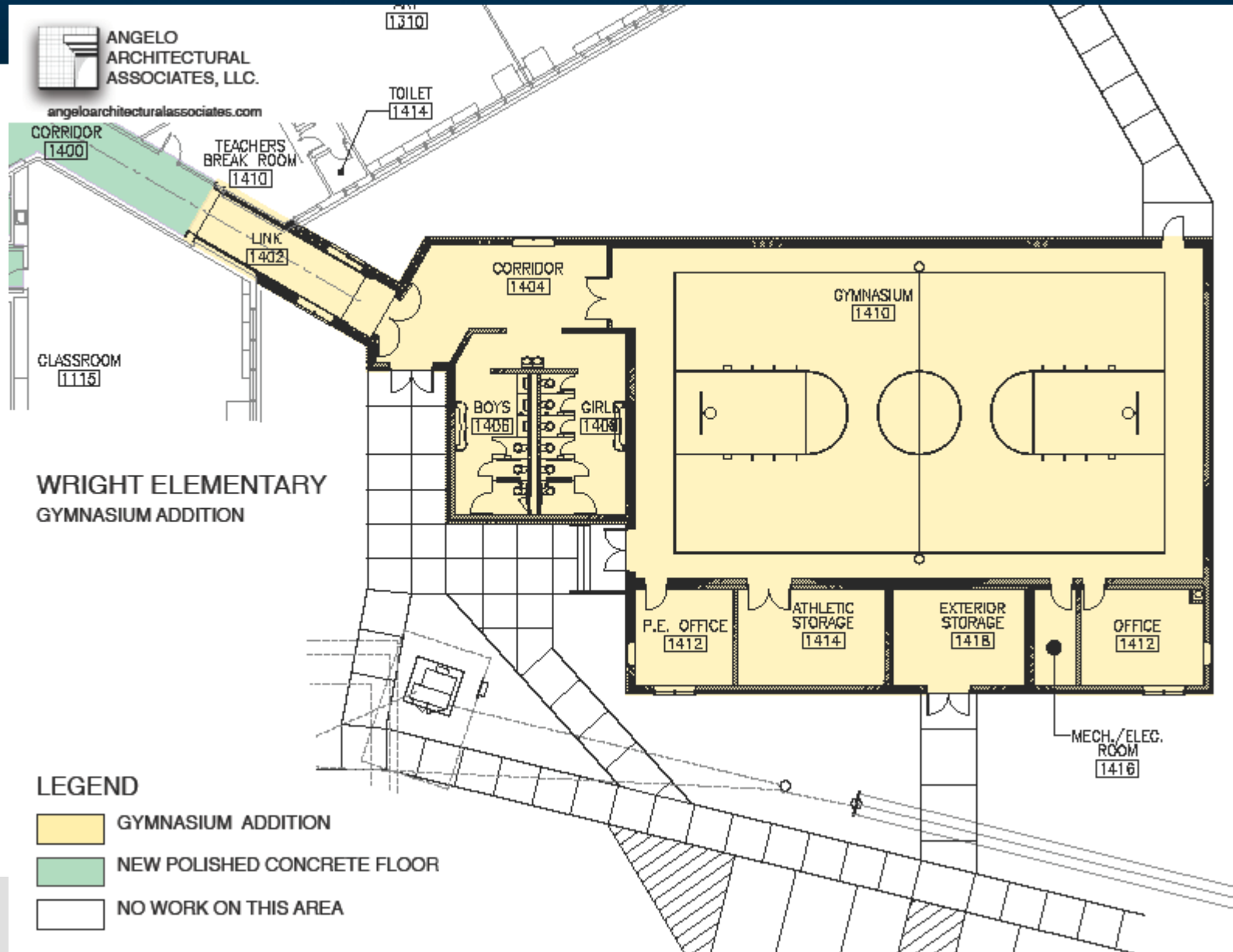

Office plan



ANGELO
ARCHITECTURAL
ASSOCIATES, LLC.

angeloarchitecturalassociates.com

WRIGHT ELEMENTARY SECURE ENTRY AND OFFICE ADDITION

LEGEND

- OFFICE ADDITION
- EXISTING OFFICE RENOVATION
- EXISTING REST ROOM RENOVATION
- NEW POLISHED CONCRETE FLOOR
- NO WORK ON THIS AREA

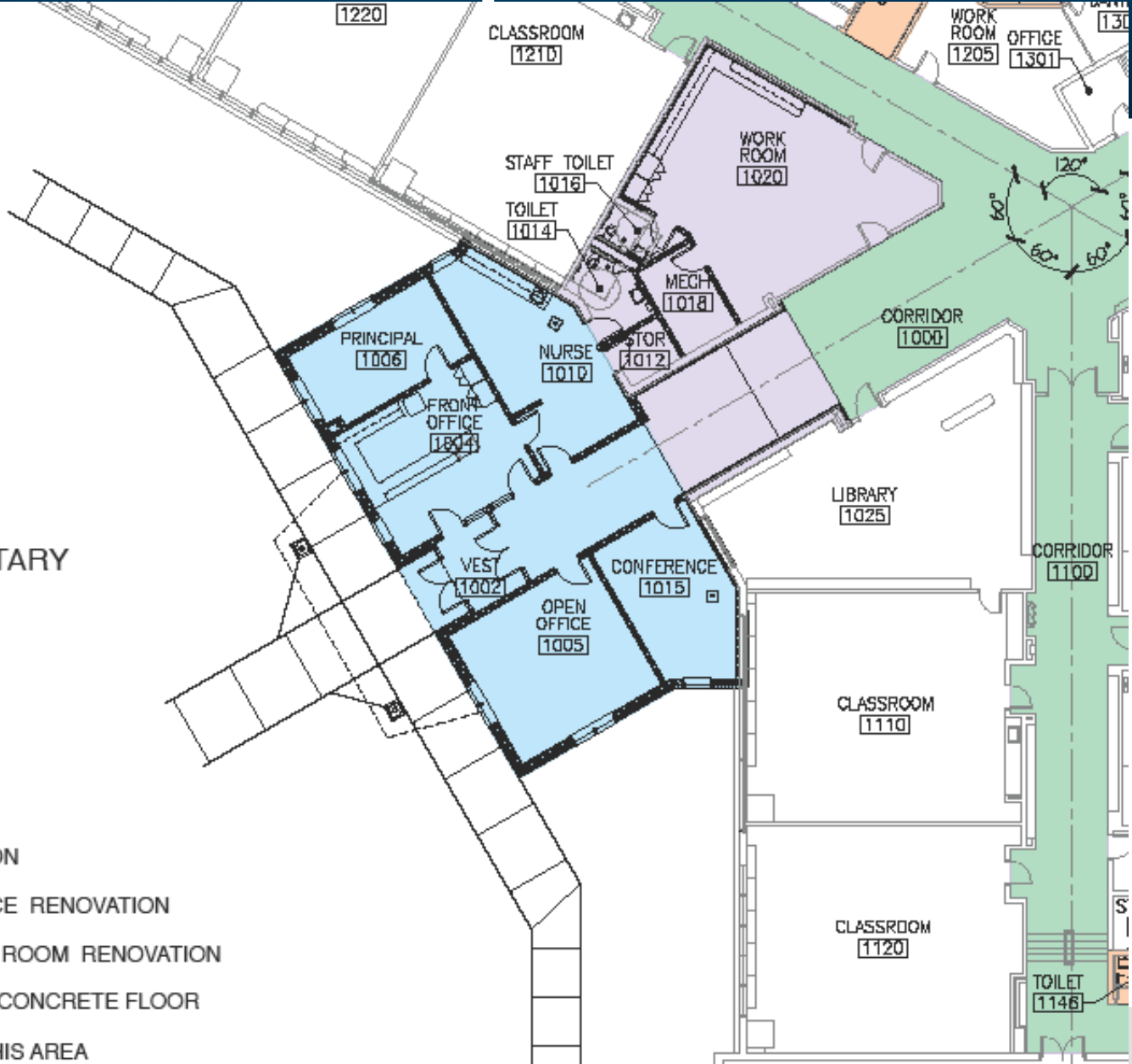

Highlights of project

- Ability to schedule P.E. activities better for students.
- Improved safety/security and first impression.
- Improved spaces to provide academic intervention for students.
- Improved teacher prep area.
- Improved student restrooms.
- Ability to use multipurpose spaces throughout the day (and after school) for students.
- Conference room.

Timeline

- December 13, 2016 – Board review of final plans
- June 5, 2017 – Construction start
- August 15, 2017 – Completion entrance and restrooms
- October 2017 – Gym completion

Funding

- Project budget – Estimated \$3,000,000
- Funding – Year 2 of SWP plan